

Core & Coil (71A) MH ~GT~ 450W

CORE & COIL HID MH BAL 1000W M141 5-TAP C&C

The basic ballast is the open core and coil which is most often used as a component within a lighting luminaire. The core and coil also forms the nucleus of Philips Advance's five other ballast configurations.

Product data

General Information	
ANSI Code	M141
Lamp Type	1000W MH
Number of Lamps	1 piece/unit
Circuit Type	SUPER-CWA
Ballast Type	Magnetic HID
Base Model	71A6553
Core Size	4 1/4 x 6 (2 Coil)
Suitable For Outdoor Use	Yes
Ignitor Catalog Number	LI572-H5
Ignitor Temperature Rating	105°C
Capacitor Value	24 MFD
Capacitor Catalog Number	MD2409000
Capacitor Requirements	480V
Capacitor Temperature Rating	90°C
Capacitor Diameter/Oval	1.75 in
Dimensions	
Capacitor Height	3.9 in
Automatic Restart	No

Operating and Electrical	
Input Voltage	120/208/240/277/480 V
Input Frequency	60 Hz
Inp. Current (Open Circuit)	5.16/4.3/3.09/2.61/1.6 A
Input Current (Starting)	6/2.82/3/2.3/1.53 A
Input Current (Short Circuit)	4.35-6.52/2.16-3.24/2.04-3.06/1.8-2.71/1-1.51 V
Secondary Short Circuit Current	4.97-6.08 A
Constant Wattage Deviation	10%
Ballast Factor (Nom)	1
Power Factor (Nom)	0.96
Nominal Open Circuit Voltage	426 V
Input Current (Operating) (Nom)	9.05/5.6/4.7/4.07/2.36 A A
Input Power (Nom)	1080 W
Rated Lamp Watts	1000 W
Wiring	
Wire Striplength	0.5 mm
Wire Length by Color	12"
Wire Type	Stranded

Core & Coil (71A) MH ~GT~ 450W

Remote Wiring Configuration Allowed	Yes
Max Ballast-Lamp Distance Remote Wiring	5'
Recommended Fuse Value	22/15/12/10/6 A
Approval and Application	
Open Circuit Voltage Test (Volts)	383-468 V
Approbation Marks	ULR CSA certificate RoHS Compliant
Temperature Marking	D/D/B/B/B
UL Recognized	Yes
Hipot Test (1 Minute)	2000 V
Hipot Test (2 Seconds)	2500 V

UL Insulation Class	H(180°C)
UL Temperature Code	1029D
Product Data	
Order product name	CORE & COIL HID MH BAL 1000W M141 5-TAP C&C
EAN/UPC - Product	781087073346
Order code	71A6553500
Numerator - Quantity Per Pack	1
Numerator - Packs per outer box	2
Material Nr. (12NC)	913710668402
Net Weight (Piece)	10.719 kg

Dimensional drawing

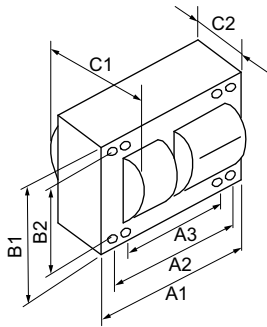

MH BAL 1000W M141 5-TAP C&C

Product	C1	C2	A1	A2	A3	B1	B2
CORE & COIL HID 71A6553500	4.7 in	3 in	6 in	5.4 in	4.4 in	4.3 in	3.9 in

