



Core & Coil (71A) MH 175W - 450W

CORE & COIL HID MH BAL 250W M138/153 480V/120T C&C

The basic ballast is the open core and coil which is most often used as a component within a lighting luminaire. The core and coil also forms the nucleus of Philips Advance's five other ballast configurations.

Product data

| General Information | |
|------------------------------------|------------------------|
| ANSI Code | M138-M153 |
| Lamp Type | 250W MH |
| Number of Lamps | 1 piece/unit |
| Circuit Type | SUPER-CWA |
| Ballast Type | Magnetic HID |
| Base Model | 71A5742TEE |
| Core Size | 4 1/4 x 4 3/4 (2 coil) |
| Suitable For Outdoor Use | Yes |
| Ignitor Catalog Number | LI533-H4 |
| Ignitor Temperature Rating | 105°C |
| Capacitor Value | 17 MFD |
| Capacitor Catalog Number | 7C170P40 |
| Capacitor Requirements | 340V |
| Capacitor Temperature Rating | 105°C |
| Capacitor Diameter/Oval Dimensions | 1.75 in |
| Capacitor Height | 3.75 in |
| Automatic Restart | No |

| Operating and Electrical | |
|---------------------------------|-------------|
| Input Voltage | 480/120T V |
| Input Frequency | 60 Hz |
| Inp. Current (Open Circuit) | 0.47 A |
| Input Current (Starting) | 0.41 A |
| Input Current (Short Circuit) | 0.33-0.50 A |
| Secondary Short Circuit Current | 2.44-2.99 A |
| Constant Wattage Deviation | 10% |
| Ballast Factor (Nom) | 1 |
| Power Factor (Nom) | 0.90 |
| Nominal Open Circuit Voltage | 290 V |
| Input Current (Operating) (Nom) | 0.64 A A |
| Input Power (Nom) | 283 W |
| Rated Lamp Watts | 250 W |

| Wiring | |
|-------------------------------------|----------|
| Wire Striplength | 0.5 mm |
| Wire Length by Color | 12" |
| Wire Type | Stranded |
| Remote Wiring Configuration Allowed | Yes |

Core & Coil (71A) MH 175W - 450W

| | |
|---|-----|
| Max Ballast-Lamp Distance Remote Wiring | 2' |
| Recommended Fuse Value | 2 A |

Approval and Application

| | |
|-----------------------------------|---|
| Open Circuit Voltage Test (Volts) | 261-319 V |
| Approbation Marks | ULR CSA certificate EISA RoHS Compliant |
| Temperature Marking | A |
| UL Recognized | Yes |
| Hipot Test (1 Minute) | 2000 V |
| Hipot Test (2 Seconds) | 2500 V |
| UL Insulation Class | H(180°C) |
| UL Temperature Code | 1029A |

Product Data

| | |
|---------------------------------|--------------------------------|
| Order product name | CORE & COIL HID 71A5742510DTEE |
| EAN/UPC - Product | 781087076019 |
| Order code | 71A5742510DTEE |
| Numerator - Quantity Per Pack | 1 |
| Numerator - Packs per outer box | 3 |
| Material Nr. (12NC) | 913710678002 |
| Net Weight (Piece) | 4.523 kg |

Dimensional drawing

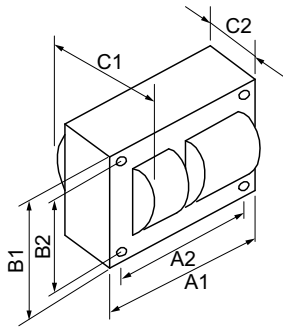

MH BAL 250W M138/153 480V/120T C&C

| Product | C1 | C2 | A1 | A2 | B1 | B2 |
|--------------------------------|---------|---------|--------|--------|--------|--------|
| CORE & COIL HID 71A5742510DTEE | 4.05 in | 2.15 in | 4.8 in | 4.4 in | 4.3 in | 3.9 in |

