



# Core & Coil (71A) MH 175W – 450W

## CORE & COIL HID MH BAL 200W M136 QUAD C&C

The basic ballast is the open core and coil which is most often used as a component within a lighting luminaire. The core and coil also forms the nucleus of Philips Advance's five other ballast configurations.

### Product data

| General Information                |                   |   |   |
|------------------------------------|-------------------|---|---|
| ANSI Code                          | M136              | Inp. Current (Open Circuit)             | 1.85/1.06/0.91/0.8 A                      |
| Lamp Type                          | 200W MH           | Input Current (Starting)                | 0.82/0.47/0.4/0.35 A                      |
| Number of Lamps                    | 1 piece/unit      | Input Current (Short Circuit)           | 0.47-0.71/0.28-0.42/0.24-0.36/0.21-0.31 A |
| Circuit Type                       | SUPER-CWA         | Secondary Short Circuit Current         | 1.95-2.4 A                                |
| Ballast Type                       | Magnetic HID      | Constant Wattage Deviation              | 10%                                       |
| Base Model                         | 71A5692EE         | Ballast Factor (Nom)                    | 1.0                                       |
| Core Size                          | 3 X 4 (2 coil)    | Power Factor (Nom)                      | 0.90                                      |
| Suitable For Outdoor Use           | Yes               | Nominal Open Circuit Voltage            | 240 V                                     |
| Ignitor Catalog Number             | LI533-H4          | Input Current (Operating) (Nom)         | 2.12/1.22/1.06/0.93 A A                   |
| Ignitor Temperature Rating         | 105°C             | Input Power (Nom)                       | 227 W                                     |
| Capacitor Value                    | 15 MFD            | Rated Lamp Watts                        | 200 W                                     |
| Capacitor Requirements             | 330V              | Wiring                                  |   |
| Capacitor Temperature Rating       | 105°C             | Wire Striplength                        | 0.5 mm                                    |
| Capacitor Diameter/Oval Dimensions | 1.65 in           | Wire Length by Color                    | 12"                                       |
| Capacitor Height                   | 3.75 in           | Wire Type                               | Stranded                                  |
| Automatic Restart                  | No                | Remote Wiring Configuration Allowed     | Yes                                       |
| Operating and Electrical           |                   | Tandem Wiring Configuration Allowed     | No  |
| Input Voltage                      | 120/208/240/277 V | Through Wiring Configuration Allowed    | No  |
| Input Frequency                    | 60 Hz             | Max Ballast-Lamp Distance Remote Wiring | 2'  |

## Core & Coil (71A) MH 175W - 450W

|                                   |   |
|-----------------------------------|---|
| Recommended Fuse Value            | 6/4/3/3 A                               |
| <b>Mechanical and Housing</b>     |   |
| Housing                           | NA                                      |
| Housing Dimensions                | NA                                      |
| <b>Approval and Application</b>   |   |
| Open Circuit Voltage Test (Volts) | 225-265 V                               |
| EMC Immunity Standard             | NA                                      |
| Approbation Marks                 | ULR CSA certificate EISA RoHS Compliant |
| Temperature Marking               | A/A/A/A                                 |
| Sound Rating                      | NA                                      |
| UL Recognized                     | Yes                                     |
| Hipot Test (1 Minute)             | 2000 V                                  |

|                                 |                               |
|---------------------------------|-------------------------------|
| Hipot Test (2 Seconds)          | 2500 V                        |
| UL Insulation Class             | H(180°C)                      |
| UL Temperature Code             | 1029A                         |
| <b>Product Data</b>             |                               |
| Order product name              | CORE & COIL HID 71A5692520DEE |
| EAN/UPC - Product               | 781087077450                  |
| Order code                      | 71A5692520DEE                 |
| Numerator - Quantity Per Pack   | 1                             |
| Numerator - Packs per outer box | 4                             |
| Material Nr. (12NC)             | 913710694802                  |
| Net Weight (Piece)              | 4.278 kg                      |

### Dimensional drawing

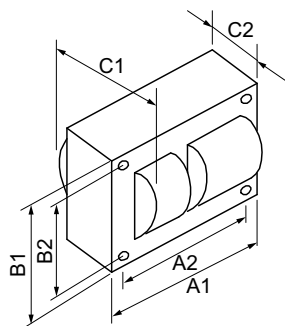

MH BAL 200W M136 QUAD C&C

| Product                       | C1      | C2      |
|-------------------------------|---------|---------|
| CORE & COIL HID 71A5692520DEE | 4.20 in | 2.95 in |

