



HID-CertaVision for CDM

HID-CV 150 /S CDM 220-240 50/60Hz

HID-CertaVision electronic ballast for use with ceramic metal-halide (CDM) lamps

Product data

Operating and Electrical		Mechanical and Housing	
Input Voltage	220 to 240 V	Housing	/S
Line Frequency	50 to 60 Hz		
Input Frequency	50 to 60 Hz	Approval and Application	
Inrush Current Width	0.60 ms	Approval Marks	F-Marking CE marking ENEC certificate
Inrush Current Peak (Nom)	55 A		
Number of Products on MCB (16A Type B) (Nom)	24	Product Data	
		Order product name	HID-CV 150 /S CDM 220-240 50/60Hz
Wiring		Full product name	HID-CV 150 /S CDM 220-240 50/60Hz
Cable Length From Device to Lamp	1.5 m	Full product code	694793917414000
Connector Type	Push	Order code	913712003813
		Material Nr. (12NC)	913712003813
Temperature		Numerator - Quantity Per Pack	1
Ambient temperature range	-20 °C to 55 °C	EAN/UPC - Product/Case	6947939174140
T-Case Lifetime (Nom)	85 °C	Numerator - Packs per outer box	12
T-Case Maximum (Max)	85 °C	EAN/UPC - Case	6947939174157

HID-CertaVision for CDM

Dimensional drawing

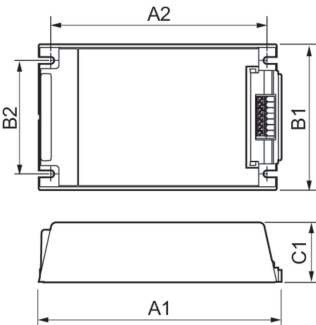

Product	C1	A1	A2	B1	B2	B3
HID-CV 150 /S CDM 220-240 50/60Hz	38.0 mm	150.0 mm	133.6 mm	90.0 mm	70.0 mm	4.3 mm

