



# HID-Basic ballasts for HPL and HPI(PLUS) lamps

## BPI 400L 200 TS

The HID-Basic ballast is an impregnated (HID standard) electromagnetic ballast for HID lamps, for use in combination with an external ignitor.

### Product data

General Information		Temperature	
Application code	L200 TS	T winding (max.)	130 °C
		Delta-T normal conditions	75 °C
Operating and Electrical		Approval and Application	
Input voltage	220 V	Approval marks	CE marking CCC certificate
Input frequency	50 Hz	Product Data	
Power factor 100% load (min.)	0.85	Full product code	694818229958100
Mains voltage performance (AC)	-8%~+6%	Order product name	BPI 400L 200 TS
Mains voltage safety (AC)	-10%~+10%	EAN/UPC – product	6948182295835
Input current with PF correction	3.15 A	Order code	913713016742
Input current without PF Correction	3.25/3.4 A	Numerator – quantity per pack	1
Power factor without PF compensation (nom.)	0.55	Numerator – packs per outer box	6
Power losses (nom.)	21.8/23.8 W	Material no. (12NC)	913713016742
Wiring		Net weight (piece)	2.849 kg
Connector type	Screw		
System characteristics			
Rated ballast-lamp power	400 W		

## HID-Basic ballasts for HPL and HPI(PLUS) lamps

### Dimensional drawing

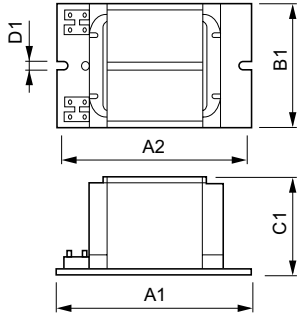

Product	D1	C1	A1	A2	B1
BPI 400L 200 TS	6.2 mm	64.5 mm	150 mm	135 mm	72.5 mm

BPI 400 L200 TS

