



HID-Basic ballasts for HPL and HPI(PLUS) lamps

BHLE 250L 201

The HID-Basic ballast is an impregnated (HID standard) electromagnetic ballast for HID lamps, for use in combination with an external ignitor.

Product data

| General Information | | Temperature | |
|--|-------------|---------------------------------|-----------------|
| Application Code | L201 | T-Winding (Max) | 130 °C |
| | | Delta-T Normal Conditions | 70/75 °C |
| Operating and Electrical | | Approval and Application | |
| Input Voltage | 220 V | Approval Marks | CE marking |
| Input Frequency | 60 Hz | | |
| Power Factor 100% Load (Min) | 0.85 | Product Data | |
| Mains Voltage Performance (AC) | -8% - +6% | Full product code | 872790084177000 |
| Mains Voltage Safety (AC) | -10% - +10% | Order product name | BHLE 250L 201 |
| Input Current with PF Correction | 1.35 A | EAN/UPC - Product | 8711500997883 |
| Input Current without PF Correction | 2.13/2.15 A | Order code | 913713016950 |
| Power Factor without PF Compensation (Nom) | 0.60 | Numerator - Quantity Per Pack | 1 |
| Power Losses (Nom) | 19.5 W | Numerator - Packs per outer box | 6 |
| | | Material Nr. (12NC) | 913713016950 |
| Wiring | | Net Weight (Piece) | 1.800 kg |
| Connector Type | Screw | | |
| System characteristics | | | |
| Rated Ballast-Lamp Power | 250 W | | |

HID-Basic ballasts for HPL and HPI(PLUS) lamps

Dimensional drawing

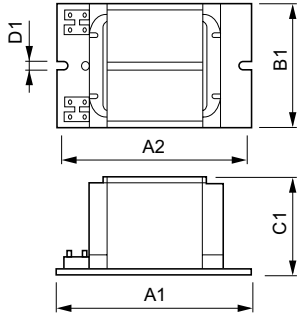

| Product | D1 | C1 | A1 | A2 | B1 |
|---------------|--------|---------|----------|----------|---------|
| BHLE 250L 201 | 6.2 mm | 64.5 mm | 132.5 mm | 119.0 mm | 75.5 mm |

BHL E 250 L201

