



# HID-Basic ballasts for HPL and HPI(PLUS) lamps

## BHL E 250 L202

The HID-Basic ballast is an impregnated (HID standard) electromagnetic ballast for HID lamps, for use in combination with an external ignitor.

### Product data

General Information	
Application code	L202
Operating and Electrical	
Input Voltage	230 V
Input frequency	50 Hz
Power factor 100% load (min.)	0.85
Mains voltage performance (AC)	-8% - +6%
Mains voltage safety (AC)	-10% - +10%
Input current with PF correction	1.35 A
Input current without PF Correction	2.13/2.15 A
Power factor without PF compensation (nom.)	0.60
Power losses (nom.)	21.6 W
Wiring	
Connector type	Screw
System characteristics	
Rated ballast-lamp power	250 W

Temperature	
T-winding (max.)	130 °C
Delta-T normal conditions	70/75 °C
Approval and Application	
Approval marks	CE marking
Product Data	
Full product code	872790084179400
Order product name	BHLE 250L 202
EAN/UPC – product	8711500997906
Order code	84179400
SAP numerator – quantity per pack	1
Numerator – packs per outer box	6
Material no. (12 NC)	913713017550
SAP net weight (piece)	2.070 kg

## HID-Basic ballasts for HPL and HPI(PLUS) lamps

### Dimensional drawing

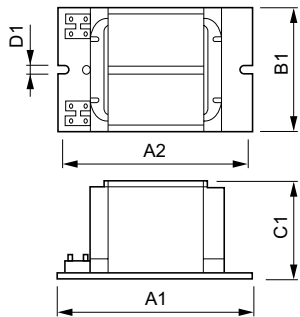

Product	D1	C1	A1	A2	B1
BHLE 250L 202	6.2 mm	64.5 mm	132.5 mm	119.0 mm	75.5 mm

BHL E 250 L202

