



HID-Basic ballasts for HPL and HPI(PLUS) lamps

BHL E 400 L202

The HID-Basic ballast is an impregnated (HID standard) electromagnetic ballast for HID lamps, for use in combination with an external ignitor.

Product data

General information	
Application code	L202
Operating and electrical	
Input Voltage	230 V
Input frequency	50 Hz
Power factor 100% load (min.)	0.85
Mains voltage performance (AC)	-8%+6%
Mains voltage safety (AC)	-10%+10%
Input current with PF correction	2.15 A
Input current without PF Correction	3.25/3.4 A
Power factor without PF compensation (nom.)	0.60
Power losses (nom.)	27.5/30.5 W
Wiring	
Connector type	Screw
System characteristics	
Rated ballast-lamp power	400 W

Temperature	
T-winding (max.)	130 °C
Delta-T normal conditions	70 °C to 75 °C
Approval and application	
Approval marks	CE marking
Product data	
Full product code	872790084180000
Order product name	BHLE 400L 202
EAN/UPC – product	8711500997913
Order code	84180000
SAP numerator – quantity per pack	1
Numerator – packs per outer box	6
SAP material	913713017650
Copy Net Weight (Piece)	3.140 kg

HID-Basic ballasts for HPL and HPI(PLUS) lamps

Dimensional drawing

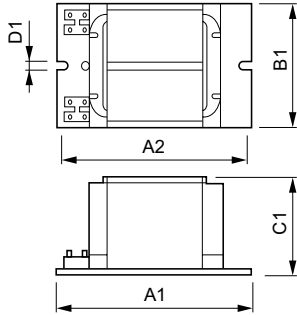

Product	D1	C1	A1	A2	B1
BHLE 400L 202	6.2 mm	64.5 mm	165.0 mm	144.0 mm	75.5 mm

BHLE 400L 202

