

HID-Basic Semi-Parallel ballasts for SON/CDM/MH lamps

BSNE 400L 300I TS

The HID Basic Semi-Parallel ballast is an impregnated (HID standard) electromagnetic copper/iron ballast for use with an external ignitor for HID lamps.

Product data

General Information		Temperature	
Application code	L300 ITS	T winding (max.)	130 °C
Design	-	Delta-T normal conditions	70 °C
Operating and Electrical		Approval and Application	
Input voltage	220 V	Approval marks	CE marking CCC certificate
Input frequency	50 Hz	Product Data	
Power factor 100% load (min.)	0.45	Full product code	694818229508800
Mains voltage performance (AC)	-8%+6%	Order product name	BSNE 400L 300I TS
Mains voltage safety (AC)	-10%+10%	EAN/UPC – product	6948182295088
Input current with PF correction	2.4 A	Order code	913713019559
Input current without PF Correction	4.6 A	Numerator – quantity per pack	1
Power factor without PF compensation (nom.)	0.85	Numerator – packs per outer box	4
Power losses (nom.)	31.8 W	Material no. (12NC)	913713019559
Wiring		Net weight (piece)	4.500 kg
Connector type	Screw		
System characteristics			
Rated ballast-lamp power	400 W		

HID-Basic Semi-Parallel ballasts for SON/CDM/MH lamps

Dimensional drawing

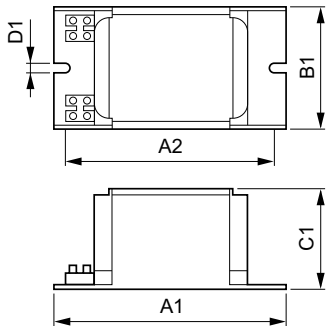

Product	D1	C1	A1	A2	B1
BSNE 400L 300I TS	6.3 mm	82 mm	165.0 mm	144 mm	96.0 mm

BSNE 400 L300 ITS

