



# HF-Selectalume II for TL-D lamps

## HF-S 218/236 TL-D II 220-240V 50/60Hz

HF-Selectalume II is the most cost-effective, reliable, slim and affordable fluorescent solution, with highly disruptive technology for energy saving, system flexibility and unsurpassed performance. The cost-saving HF-Selectalume II has a robust design which meets all relevant international safety and performance standards. HF-Selectalume II is intended for use with indoor lighting fixtures such as spotlights, downlights and recessed luminaires, which are largely used in office, retail, industry, hotel, restaurant and other applications where control devices are installed with occasional On/Off switching activity

### Product data

Operating and Electrical		T-Case Lifetime (Nom)		75 °C
Input Voltage	220 to 240 V	T-Case Maximum (Max)		75 °C
Line Frequency	50 to 60 Hz			
Input Frequency	50 to 60 Hz	Mechanical and Housing		
Earth Leakage Current (Max)	0.5 mA	Housing		L 280x30x28
Inrush Current Width	0.35 ms			
Inrush Current Peak (Max)	18 A	Approval and Application		
Number of Products on MCB (16A Type B) (Nom)	28	Ingress protection code	IP20 [Finger-protected]	
		Energy Efficiency Index	A2 BAT	
		Approval Marks	F-Marking CE marking ENEC certificate CCC certificate C-Tick certificate PSB certification TISI marking SIRIM approval CB Certificate CCC certificate VDE-EMV certificate	
Wiring		Product Data		
Connector Type Input Terminals	WAGO 744 connector	Order product name	HF-S 218/236 TL-D II 220-240V 50/60Hz	
Connector Type Output Terminals	WAGO 744 connector [Suitable for manual wiring]	Full product name	HF-S 218/236 TL-D II 220-240V 50/60Hz	
Temperature				
Ambient temperature range	-20 °C to 55 °C			

# HF-Selectalume II for TL-D lamps

Full product code	872790090553300
Order code	913713032466
Material Nr. (12NC)	913713032466
Numerator - Quantity Per Pack	1
EAN/UPC - Product/Case	8711500999313

Numerator - Packs per outer box	12
EAN/UPC - Case	8727900905533

## Dimensional drawing

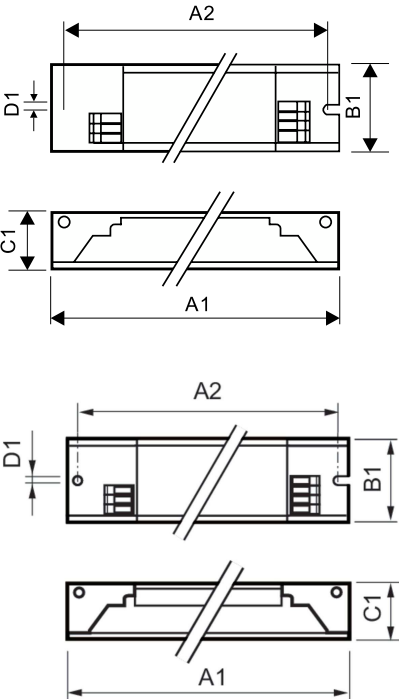

Product	HF-S 218/236 TL-D II 220-240V 50/60Hz
---------	---------------------------------------

Product	A1	B1	C1	A2	B2	D1
HF-S 218/236 TL-D II 220-240V 50/60Hz	280 mm	30 mm	28 mm	265 mm		4.2 mm

