



# HF-Selectalume II for TL5 lamps

## HF-S 3/414 TL5 II 220-240V 50/60Hz

HF-Selectalume II TL5 is the most cost-effective, reliable and outstanding solution for fluorescent lamps. These ballasts are part of an overall high-efficiency lighting system that may help you or your customers to achieve any international or local energy code you need to comply with. HF-Selectalume II TL5 ballasts are the ideal choice for a broad range of new construction and retrofit applications within the commercial sector, including general surface mounting or office lighting, parking garages, warehouses, waterproof and other applications.

### Product data

Operating and Electrical	
Input Voltage	220 to 240 V
Line Frequency	50 to 60 Hz
Input Frequency	50 to 60 Hz
Earth Leakage Current (Max)	0.5 mA
Inrush Current Width	0.35 ms
Inrush Current Peak (Max)	18 A
Number of Products on MCB (16A Type B) (Nom)	28
Wiring	
Connector Type Input Terminals	WAGO 744 connector
Connector Type Output Terminals	WAGO 744 connector [Suitable for manual wiring]
Temperature	
Ambient temperature range	-20 °C to 55 °C
T-Case Lifetime (Nom)	75 °C

T-Case Maximum (Max)	75 °C
Mechanical and Housing	
Housing	L 280x39x21.5
Approval and Application	
Ingress protection code	IP20 [Finger-protected]
Energy Efficiency Index	A2/A2 BAT
Approval Marks	F-Marking CE marking ENEC certificate CCC certificate C-Tick certificate PSB certification TISI marking SIRIM approval CB Certificate CCC certificate VDE-EMV certificate
Product Data	
Order product name	HF-S 3/414 TL5 II 220-240V 50/60Hz
Full product name	HF-S 3/414 TL5 II 220-240V 50/60Hz
Full product code	872790088335000
Order code	88335000

HF-Selectalume II for TL5 lamps

Material Nr. (12NC)	913713033066
Numerator - Quantity Per Pack	1
EAN/UPC - Product/Case	8711500998705
Numerator - Packs per outer box	10

EAN/UPC - Case	8727900883350
----------------	---------------

Dimensional drawing

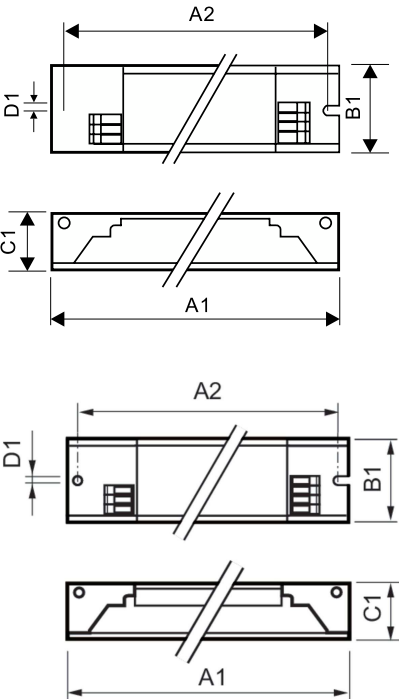

Product
HF-S 3/414 TL5 II 220-240V 50/60Hz

Product	A1	B1	C1	A2	B2	D1
HF-S 3/414 TL5 II 220-240V 50/60Hz	280 mm	39 mm	21.5 mm	265 mm		4.2 mm

