



HF-Selectalume II for TL5 lamps

HF-S 3/414 TL5 II 220-240V 50/60Hz

HF-Selectalume II TL5 is the most cost-effective, reliable and outstanding solution for fluorescent lamps. These ballasts are part of an overall high-efficiency lighting system that may help you or your customers to achieve any international or local energy code you need to comply with. HF-Selectalume II TL5 ballasts are the ideal choice for a broad range of new construction and retrofit applications within the commercial sector, including general surface mounting or office lighting, parking garages, warehouses, waterproof and other applications.

Product data

Operating and Electrical		T-Case Maximum (Max)		75 °C
Input Voltage	220 to 240 V			
Line Frequency	50 to 60 Hz	Mechanical and Housing		
Input Frequency	50 to 60 Hz	Housing		L 280x39x21.5
Earth Leakage Current (Max)	0.5 mA			
Inrush Current Width	0.35 ms	Approval and Application		
Inrush Current Peak (Max)	18 A	Ingress protection code		IP20 [Finger-protected]
Number of Products on MCB (16A Type B) (Nom)	28	Energy Efficiency Index		A2/A2 BAT
		Approval Marks		F-Marking CE marking ENEC certificate CCC certificate C-Tick certificate PSB certification TISI marking SIRIM approval CB Certificate CCC certificate VDE-EMV certificate
Wiring				
Connector Type Input Terminals	WAGO 744 connector	Product Data		
Connector Type Output Terminals	WAGO 744 connector [Suitable for manual wiring]	Order product name		HF-S 3/414 TL5 II 220-240V 50/60Hz
		Full product name		HF-S 3/414 TL5 II 220-240V 50/60Hz
		Full product code		872790088335000
		Order code		913713033066
Temperature				
Ambient temperature range	-20 °C to 55 °C			
T-Case Lifetime (Nom)	75 °C			

HF-Selectalume II for TL5 lamps

Material Nr. (12NC)	913713033066
Numerator - Quantity Per Pack	1
EAN/UPC - Product/Case	8711500998705
Numerator - Packs per outer box	10

EAN/UPC - Case	8727900883350
----------------	---------------

Dimensional drawing

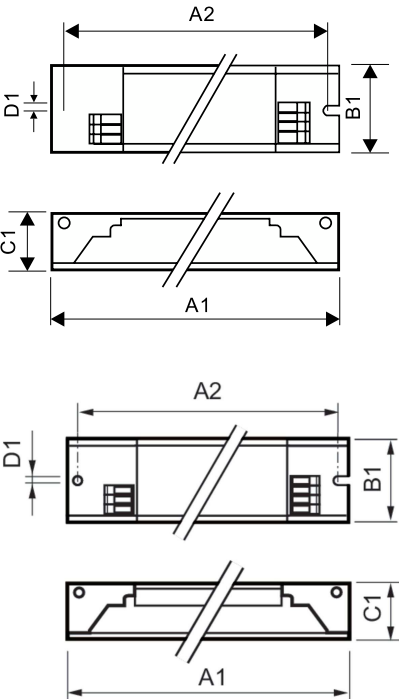

Product
HF-S 3/414 TL5 II 220-240V 50/60Hz

Product	A1	B1	C1	A2	B2	D1
HF-S 3/414 TL5 II 220-240V 50/60Hz	280 mm	39 mm	21.5 mm	265 mm		4.2 mm

