



# HF-Selectalume II for TL5 lamps

## HF-S 235 TL5 II 220-240V 50/60Hz

HF-Selectalume II is the most cost-effective, reliable, slim and affordable fluorescent solution, with highly disruptive technology for energy saving, system flexibility and unsurpassed performance. The cost-saving HF-Selectalume II has a robust design which meets all relevant international safety and performance standards. HF-Selectalume II is intended for use with indoor lighting fixtures such as spotlights, downlights and recessed luminaires, which are largely used in office, retail, industry, hotel, restaurant and other applications where control devices are installed with occasional On/Off switching activity

### Product data

Operating and Electrical	
Input Voltage	220 to 240 V
Line Frequency	50 to 60 Hz
Input Frequency	50 to 60 Hz
Earth Leakage Current (Max)	0.5 mA
Inrush Current Width	0.25 ms
Inrush Current Peak (Max)	25 A
Wiring	
Connector Type Input Terminals	WAGO 744 connector
Connector Type Output Terminals	WAGO 744 connector [Suitable for manual wiring]
Temperature	
Ambient temperature range	-15 °C to 50 °C
T-Case Lifetime (Nom)	75 °C
T-Case Maximum (Max)	75 °C

Mechanical and Housing	
Housing	L 280x30x21.5
Approval and Application	
Ingress protection code	IP20 [Finger-protected]
Energy Efficiency Index	A2
Approval Marks	F-Marking CE marking ENEC certificate CCC certificate C-Tick certificate PSB certification TISI marking SIRIM approval CB Certificate CCC certificate VDE-EMV certificate
Product Data	
Order product name	HF-S 235 TL5 II 220-240V 50/60Hz
Full product name	HF-S 235 TL5 II 220-240V 50/60Hz
Full product code	872790088334300
Order code	913713033366
Material Nr. (12NC)	913713033366

HF-Selectalume II for TL5 lamps

Numerator - Quantity Per Pack	1
EAN/UPC - Product/Case	8711500998699
Numerator - Packs per outer box	12

EAN/UPC - Case	8727900883343
----------------	---------------

Dimensional drawing

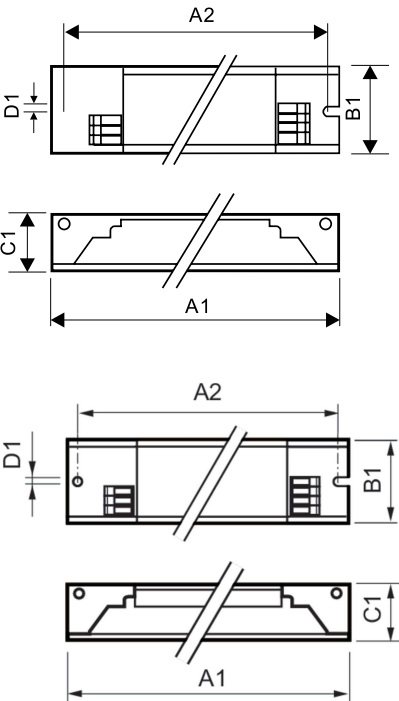

Product
HF-S 235 TL5 II 220-240V 50/60Hz

Product	A1	B1	C1	A2	B2	D1
HF-S 235 TL5 II 220-240V 50/60Hz	280 mm	30 mm	21.5 mm	265 mm		4.2 mm

