



# HF-Performer III for TL5 lamps

## HF-P 2 24/39 TL5 III 220-240V 50/60Hz

HF-Performer III TL5 is a sustainable, slim and high-frequency electronic ballast for TL5 and TL5 Eco fluorescent lamps. It is ideal for applications where high energy efficiency is required. The HF-Performer III range has a robust design, meets all relevant international safety and performance standards and is energy-efficient (CELMA EEI A2 BAT).

### Product data

Operating and Electrical	
Input Voltage	220 to 240 V
Line Frequency	50 to 60 Hz
Input Frequency	50 to 60 Hz
Inrush Current Width	0.30 ms
Inrush Current Peak (Max)	24 A
Number of Products on MCB (16A Type B) (Nom)	20
Wiring	
Connector Type Input Terminals	WAGO 251 universal connector [Suitable for both automatic wiring (ALF and ADS) and manual wiring]
Connector Type Output Terminals	WAGO 251 universal connector [Suitable for both automatic wiring (ALF and ADS) and manual wiring]
Temperature	
Ambient temperature range	-25 °C to 60 °C
T-Case Lifetime (Nom)	80 °C

T-Case Maximum (Max)	80 °C
Mechanical and Housing	
Housing	L 360x30x21
Approval and Application	
Ingress protection code	IP20 [Finger-protected]
Energy Efficiency Index	A2 BAT
Safety Standard	IEC 61347-2-3
Environmental Standard	ISO 14001
Approval Marks	CE marking ENEC certificate VDE-EMV certificate
Product Data	
Order product name	HF-P 2 24/39 TL5 III 220-240V 50/60Hz
Full product name	HF-P 2 24/39 TL5 III 220-240V 50/60Hz
Full product code	872790095226100
Order code	913713034166
Material Nr. (12NC)	913713034166
Numerator - Quantity Per Pack	1

# HF-Performer III for TL5 lamps

EAN/UPC - Product/Case	8727900952261
Numerator - Packs per outer box	12
EAN/UPC - Case	8727900952278

## Dimensional drawing

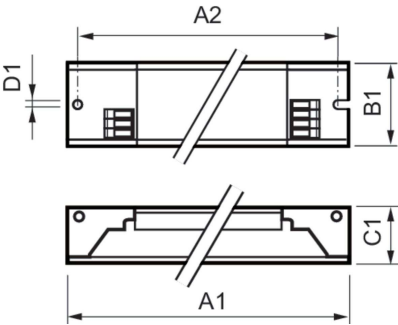

Product	D1	C1	A1	A2	B1
HF-P 2 24/39 TL5 III 220-240V 50/60Hz	4.2 mm	21.0 mm	360.0 mm	350.0 mm	30.0 mm

