



# HF-Selectalume II for TL5 lamps

## HF-S 124/39 TL5 II 220-240V 50/60Hz

HF-Selectalume II TL5 is the most cost-effective, reliable and outstanding solution for fluorescent lamps. These ballasts are part of an overall high-efficiency lighting system that may help you or your customers to achieve any international or local energy code you need to comply with. HF-Selectalume II TL5 ballasts are the ideal choice for a broad range of new construction and retrofit applications within the commercial sector, including general surface mounting or office lighting, parking garages, warehouses, waterproof and other applications.

### Product data

General Information	
Application code	II
Type version	mk1
Lamp type	TL5
Number of lamps	1 piece/unit
Automatic restart	Yes
Operating and Electrical	
Input Voltage	220 to 240 V
Input frequency	50 to 60 Hz
Operating frequency (nom.)	45 kHz
Crest factor (nom.)	1.7
Power factor 100% load (nom.)	0.98
Preheat time	1.6 s
Mains voltage performance (AC)	202-254V-8%-+6%
Mains voltage safety (AC)	198-264V-10%-+10%
Earth leakage current (max.)	0.5 mA
Inrush current width	0.28 ms

Ballast factor (nom.)	1.05
Power losses (nom.)	3.5/4 W
Inrush current peak (max.)	20 A
Wiring	
Connector type input terminals	WAGO 744 connector
Cable capacity output wires mutual (max.)	200 pF
Connector type output terminals	WAGO 744 connector [ Suitable for manual wiring]
Cable length hot-wiring	0.75 m
Wire strip length	8.0-9.0 mm
Dual fixture master/slave	Possible, lamp wires 2m max. length [ Master/Slave operation possible]
Input terminal cross section	0.50-1.50 mm <sup>2</sup>
Output terminal cross section	0.50-1.50 mm <sup>2</sup>
Cable capacity cold output wires – earth (max.)	200 pF

## HF-Selectalume II for TL5 lamps

Cable capacity hot output wires – earth (max.)	200 pF
--	--------

### System characteristics

Rated ballast-lamp power	24/39 W
Rated lamp power on TL5	24/39 W
System power on TL5	27/42 W
Lamp power on TL5	23.5/38 W
Power loss on TL5	3.5/4 W

### Temperature

T-ambient (max.)	50 °C
T-ambient (min.)	-15 °C
T storage (max.)	80 °C
T storage (min.)	-40 °C
T-case lifetime (nom.)	75 °C
T-Case maximum (max.)	75 °C

### Mechanical and Housing

Housing	L 280x30x21.5
---------	---------------

### Emergency Operation

Nominal light output after 60 seconds	100% of EBLF
Normal operating voltage (DC)	220-240 V
Battery voltage guaranteed operation	176-275 V
Battery voltage guaranteed ignition	186-275 V
Emergency ballast lumen factor (EBLF) (nom.)	100 %

Nominal light output after 5 seconds	50% of EBLF
--------------------------------------	-------------

### Approval and Application

Energy efficiency index	A2/A2BAT
IP classification	IP 20 [ Ingress Protection 20]
EMI 9 kHz ... 30 MHz	EN55015
Vibration standard	IEC68-2-6 F c
Bumps standard	IEC 68-2-29 Eb (10G/16ms)
Approval marks	F-Marking CE marking ENEC certificate CCC certificate C-Tick certificate PSB certification TISI marking SIRIM approval CB Certificate CCC certificate VDE-EMV certificate
Humming and noise level	< 30 dB(A)

### Product Data

Full product code	872790093933000
Order product name	HF-S 124-39 TL5 II 220-240V 50/60Hz
EAN/UPC – product	8727900939330
Order code	93933000
Numerator – quantity per pack	1
Numerator – packs per outer box	12
SAP material	913713034466
SAP net weight (piece)	0.190 kg

## Dimensional drawing

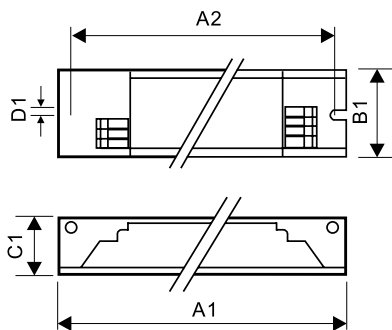

HF-S 124-39 TL5 II 220-240V 50/60Hz

### Product

HF-S 124-39 TL5 II 220-240V 50/60Hz

## HF-Selectalume II for TL5 lamps

