

# HF-Selectalume II for PL-T/C Strain Relief

## HF-S 1/218 PL-T/C II SR 220-240V 50/60Hz

HF-Selectalume II independent version is the most cost-effective, reliable, slim and affordable fluorescent solution, with highly disruptive technology for energy saving, system flexibility and unsurpassed performance. The cost-saving HF-Selectalume II PLTC SR has a robust design which meets all relevant international safety and performance standards. The HF-S II strain relief is optimized mainly for PL-T/C lamps. HF-Selectalume II is intended for use with indoor lighting fixtures such as spotlights, downlights and recessed luminaires, which are largely used in office, retail, industry, hotel, restaurant and other applications.

### Product data

General Information	
Application Code	II SR
Type Version	SR
Lamp Type	PL-T/C
Number of Lamps	2 piece/unit
Number of Products on MCB (16A Type B) (Nom)	28
Automatic Restart	Yes

Operating and Electrical	
Input Voltage	220 to 240 V
Input Frequency	50 to 60 Hz
Operating Frequency (Nom)	45 kHz
Crestfactor (Nom)	1.7
Power Factor 100% Load (Nom)	0.95
Preheat Time	1.95 s
Mains Voltage Performance (AC)	202...254V

Mains Voltage Safety (AC)	198...264V
Earth Leakage Current (Max)	0.5 mA
Inrush Current Width	0.25 ms
Ballast Factor (Nom)	1
Power Losses (Nom)	1.17 W
Inrush Current Peak (Max)	18 A

Wiring	
Connector Type Input Terminals	WAGO 250 connector [ Suitable for manual wiring]
Connector Type Output Terminals	WAGO 250 connector [ Suitable for manual wiring]
Cable Length Hot Wiring	1 m
Wire Striplength	8.5-9.5 mm
Dual Fixture Master/Slave	- [ not specified]
Input Terminal Cross Section	0.75-1.50 mm <sup>2</sup>
Output Terminal Cross Section	0.75-1.50 mm <sup>2</sup>

## HF-Selectalume II for PL-T/C Strain Relief

Cable Capacity Cold Output Wires - Earth (Nom)	100 pF
Cable Capacity Hot Output Wires - Earth (Nom)	100 pF

### System characteristics

Rated Ballast-Lamp Power	18 W
Rated Lamp Power on PL-T/C	2x18/18 W
System Power on PL-T/C	34.39/18.39 W
Power Loss on PL-T/C	2.59/2.19 W
Lamp Power on PL-T/C	31.8/16.2 W

### Temperature

T-Ambient (Max)	50 °C
T-Ambient (Min)	-25 °C
T-Storage (Max)	80 °C
T-Storage (Min)	-40 °C
T-Case Lifetime (Nom)	75 °C
T-Case Maximum (Max)	75 °C

### Mechanical and Housing

Housing	L 125.5x67.8x32.0
---------	-------------------

### Emergency Operation

Nominal Light Output After 60 Seconds	100% of EBLF
Normal Operating Voltage (DC)	220-240 V
Battery Voltage Guaranteed Operation	176-275 V
Battery Voltage Guaranteed Ignition	186-275 V

Emergency Ballast Lumen Factor (EBLF) (Nom)	100 %
Nominal Light Output After 5 Seconds	50% of EBLF

### Approval and Application

Energy Efficiency Index	A2 BAT
IP Classification	IP 20 [ Ingress Protection 20]
EMI 9 kHz ... 30 MHz	EN55015
Vibration Standard	IEC60068-2-6 Test F c
Bumps Standard	IEC 60068-2-29 test Eb
Humidity Standard	IEC 61347-2-3
Approval Marks	CE marking ENEC certificate VDE certificate VDE-EMC marking
Hum And Noise Level	30 dB(A)

### Product Data

Full product code	871829116963500
Order product name	HF-S 1/218 PL-T/C II SR 220-240V 50/60Hz
EAN/UPC - Product	8718291169635
Order code	16963500
Numerator - Quantity Per Pack	1
Numerator - Packs per outer box	12
Material Nr. (12NC)	913713035866
Net Weight (Piece)	0.156 kg

## Dimensional drawing

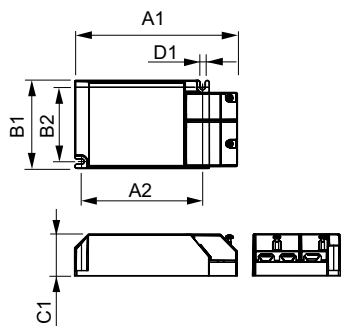

HF-S 1/218 PL-T/C II SR 220-240V 50/60Hz

Product	D1	C1	A1	A2	B1	B2
HF-S 1/218 PL-T/C II SR	4.0 mm	32.0	125.5	93.5	67.8	57.5
220-240V 50/60Hz		mm	mm	mm	mm	mm

## HF-Selectalume II for PL-T/C Strain Relief

