



# EB-Certalume for PLT/C lamps

## EB-C 218 PL-T/C 220-240V 50/60Hz

Affordable, reliable, high frequency electronic ballast for 4-pin PL-T and PL-C fluorescent lamps, ideal alternative for electromagnetic (EM) ballasts; The ballast is primarily designed for Indoor application. For outdoor application, the luminaire should be minimum Classland need to be sufficiently protected against water & dust. The installation should also be guard against any lightening surge or any other necessary electrical protection as deemed in such typical installation & application.

### Product data

| General Information                          |              |
|--|--------------|
| Type Version                                 | mk1          |
| Lamp Type                                    | PL-T/C       |
| Number of Lamps                              | 2 piece/unit |
| Number of Products on MCB (16A Type B) (Nom) | 20           |
| Automatic Restart                            | No           |
| Operating and Electrical                     |              |
| Input Voltage                                | 220 to 240 V |
| Input Frequency                              | 50 to 60 Hz  |
| Operating Frequency (Nom)                    | 42-60 kHz    |
| Crestfactor (Nom)                            | 1.9          |
| Power Factor 100% Load (Nom)                 | 0.95         |
| Mains Voltage Safety (AC)                    | -10%~+10%    |
| Earth Leakage Current (Nom)                  | 0.7 mA       |

| Wiring                                     |  |
|--|--|
| Connector Type Input Terminals             | 250 manual connector [ Suitable for manual wiring and easy release button] |
| Cable Capacity Output Wires Mutual (Max)   | 120 pF   |
| Color Input Terminals                      | Orange   |
| Color Output Terminals                     | Grey   |
| Connector Type Output Terminals            | 250 manual connector [ Suitable for manual wiring and easy release button] |
| Cable Length Hot Wiring                    | 0.75 m   |
| Wire Striplength                           | 9.0-10.0 mm  |
| Dual Fixture Master/Slave                  | Not advisable [ Master/Slave operation not advised]                        |
| Input Terminal Cross Section               | 0.50-1.50 mm <sup>2</sup>  |
| Output Terminal Cross Section              | 0.50-1.50 mm <sup>2</sup>  |
| Cable Capacity Output Wires to Earth (Max) | 120 pF   |

| System characteristics   |        |
|--------------------------|--------|
| Rated Ballast-Lamp Power | 18 W   |
| System Power on PL-T/C   | 38.0 W |

## EB-Certalume for PLT/C lamps

|                      |        |
|----------------------|--------|
| Power Loss on PL-T/C | 5.0 W  |
| Lamp Power on PL-T/C | 16.5 W |

### Temperature

|                       |       |
|-----------------------|-------|
| T-Case Lifetime (Nom) | 65 °C |
| T-Case Maximum (Max)  | 65 °C |

### Mechanical and Housing

|         |                    |
|---------|--------------------|
| Housing | - [ Not Specified] |
|---------|--------------------|

### Emergency Operation

|                               |           |
|-------------------------------|-----------|
| Battery Voltage Lamp Ignition | 165-253 V |
|-------------------------------|-----------|

### Approval and Application

|                               |                                |
|-------------------------------|--------------------------------|
| Energy Efficiency Index       | A2                             |
| IP Classification             | IP 20 [ Ingress Protection 20] |
| Overvoltage Protection 276Vac | 48 h                           |

|                      |                                |
|----------------------|--------------------------------|
| EMI 9 kHz ... 30 MHz | EN55015                        |
| Vibration Standard   | IEC68-2-6 F c                  |
| Bumps Standard       | IEC 68-2-29 Eb                 |
| Humidity Standard    | EN61347-I                      |
| Approval Marks       | CCC certificate CB Certificate |

### Product Data

|                                 |                                  |
|---------------------------------|----------------------------------|
| Full product code               | 872790083289100                  |
| Order product name              | EB-C 218 PL-T/C 220-240V 50/60Hz |
| EAN/UPC - Product               | 8711500997753                    |
| Order code                      | 913713198714                     |
| Numerator - Quantity Per Pack   | 1                                |
| Numerator - Packs per outer box | 24                               |
| Material Nr. (12NC)             | 913713198714                     |
| Net Weight (Piece)              | 0.132 kg                         |

## Dimensional drawing

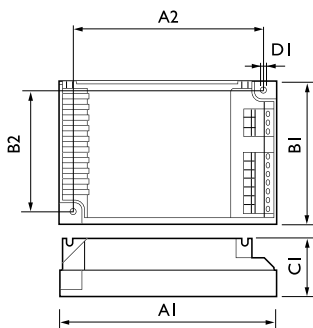

EB-C 218 PL-T/C 220-240V 50/60Hz

| Product                             | D1     | C1      | A1      | A2      | B1      |
|-------------------------------------|--------|---------|---------|---------|---------|
| EB-C 218 PL-T/C 220-240V<br>50/60Hz | 4.2 mm | 31.0 mm | 94.0 mm | 86.0 mm | 72.0 mm |

