

HID-Basic Semi-Parallel ballasts for MHN/CDM lamps

BMH 70L 300I TS

The HID Basic Semi-Parallel ballast is an impregnated (HID standard) electromagnetic copper/iron ballast for use with an external ignitor for metal-halide and CDM lamps.

Product data

Operating and Electrical		Full product name	
Input Voltage	220 V	Full product code	697480505105200
Line Frequency	50 Hz	Order code	913713200667
Input Frequency	50 Hz	Material Nr. (12NC)	913713200667
Wiring		Numerator - Quantity Per Pack	1
Connector Type	Screw	EAN/UPC - Product/Case	6974805051052
Approval and Application		Numerator - Packs per outer box	6
Approval Marks	CE marking ENEC certificate CCC certificate	EAN/UPC - Case	6974805051069
Product Data			
Order product name	BMH 70L 300I TS		

HID-Basic Semi-Parallel ballasts for MHN/CDM lamps

Dimensional drawing

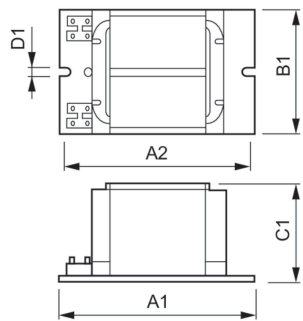

Product	D1	C1	A1	A2	B1
BMH 70L 300I TS	6.2 mm	51.5 mm	117.0 mm	102.0 mm	57.1 mm

