

HID-Basic Semi-Parallel Economic ballasts for SON/CDM/MH lamps

BMHE 210L 300I TS

The HID Basic Semi-Parallel ballast is an impregnated (HID standard) electromagnetic copper/iron ballast for use with an external ignitor for HID lamps.

Product data

Operating and Electrical	
Input Voltage	220 V
Line Frequency	50 Hz
Input Frequency	50 Hz
Power Factor (Fraction)	0.45
Wiring	
Connector Type	Screw
Approval and Application	
Approval Marks	CE marking KEMA Keur certificate CCC certificate

Product Data	
Order product name	BMHE 210L 300I TS
Full product name	BMHE 210L 300I TS
Full product code	694818220041900
Order code	913713205767
Material Nr. (12NC)	913713205767
Numerator - Quantity Per Pack	1
EAN/UPC - Product/Case	6948182200419
Numerator - Packs per outer box	6
EAN/UPC - Case	6948182200426

HID-Basic Semi-Parallel Economic ballasts for SON/CDM/MH lamps

Dimensional drawing

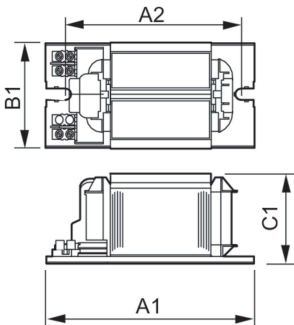

Product	C1	A1	A2	B1
BMHE 210L 300I TS		150 mm	130 mm	75 mm

