



MasterColor CDM-TM

MMC LAMPKIT CDM-TM 20W/830

Introducing the smallest 20W ceramic metal halide lamp together with the unique e-Vision® electronic ballast. It's visually pleasing and financially rewarding, so the focus can be on your merchandise and not the ceiling clutter.

Warnings and Safety

- R "WARNING: These lamps can cause serious skin burn and eye inflammation from short wave ultraviolet radiation if outer envelope of the lamp is broken or punctured. Do not use where people will remain for more than a few minutes unless adequate shielding or other safety precautions are used. Certain lamps that will automatically extinguish when the outer envelope is broken or punctured are commercially available." This lamp complies with FDA radiation performance standard 21 CFR subchapter J. (USA:21 CFR 1040.30 Canada: SOR/DORS/80-381)

Product data

General Information	
Cap-Base	PGJ5 [PGJ5]
Operating Position	UNIVERSAL [Any or Universal (U)]
Life to 50% Failures (Nom)	12,000 hour(s)
Light Technical	
Color Code	830 [CCT of 3000K]
Color Designation	Warm White (WW)
Chromaticity Coordinate X (Nom)	0.433
Chromaticity Coordinate Y (Nom)	0.392
Correlated Color Temperature (Nom)	3000 K
Luminous Efficacy (rated) (Nom)	75 lm/W
Color rendering index (CRI)	87
Arc Length O (Nom)	3 mm
Operating and Electrical	
Power Consumption	22.0 W

Voltage (Nom)	100 V
Voltage (Nom)	100 V
Controls and Dimming	
Dimmable	No
Mechanical and Housing	
Bulb Finish	Clear
Bulb Shape	T13.3 [T 13.3mm]
Approval and Application	
Mercury (Hg) Content (Nom)	2.4 mg
Energy Consumption kWh/1000 h	24 kWh
Product Data	
Order product name	MMC LAMPKIT CDM-TM 20W/830
Full product name	MMC LAMPKIT CDM-TM 20W/830

MasterColor CDM-TM

Full product code	871150020766115
Order code	914499996230
Material Nr. (12NC)	914499996230
Numerator - Quantity Per Pack	1
EAN/UPC - Product/Case	8711500207661

Numerator - Packs per outer box	12
EAN/UPC - Case	8711500207579

Dimensional drawing

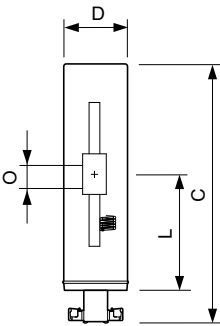

Product	D (max)	D	O	L (min)	L (max)	L	C (max)
MMC LAMPKIT CDM- TM 20W/830	13.3 mm	0.44 inch	3 mm	22.3 mm	22.9 mm	22.6 mm	52 mm

Photometric data

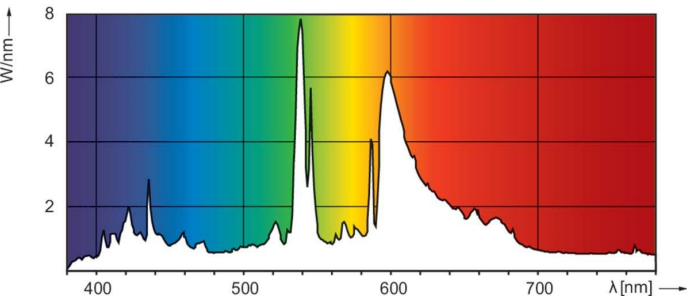
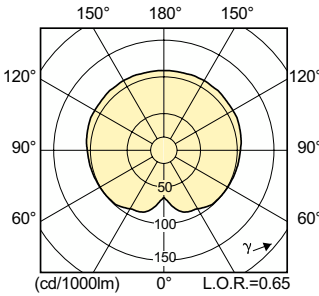
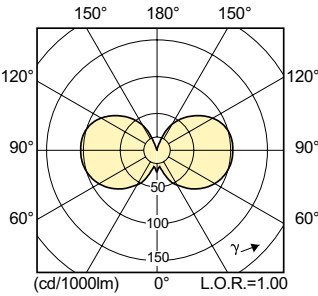

Light Distribution Diagram - MMC LAMPKIT CDM-TM 20W/830

Spectral Power Distribution Colour

Lifetime

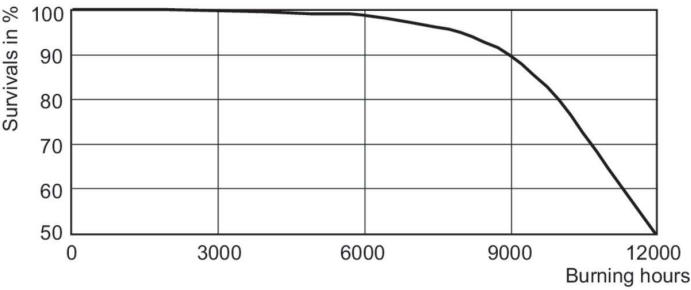

Life Expectancy Diagram - MMC LAMPKIT CDM-TM 20W/830

Lumen Maintenance Diagram - MMC LAMPKIT CDM-TM 20W/830

