



MasterColor CDM-TM

MASTERC CDM-TM MINI 35W/930 PGJ5 KIT/12

Introducing the smallest 20W ceramic metal halide lamp together with the unique e-Vision® electronic ballast. It's visually pleasing and financially rewarding, so the focus can be on your merchandise and not the ceiling clutter.

Warnings and Safety

- R "WARNING: These lamps can cause serious skin burn and eye inflammation from short wave ultraviolet radiation if outer envelope of the lamp is broken or punctured. Do not use where people will remain for more than a few minutes unless adequate shielding or other safety precautions are used. Certain lamps that will automatically extinguish when the outer envelope is broken or punctured are commercially available." This lamp complies with FDA radiation performance standard 21 CFR subchapter J. (USA:21 CFR 1040.30 Canada: SOR/DORS/80-381)

Product data

General Information	
Cap-Base	PGJ5 [PGJ5]
Operating Position	UNIVERSAL [Any or Universal (U)]
Life to 50% Failures (Nom)	12,000 hour(s)
Light Technical	
Color Code	930 [CCT of 3000K]
Color Designation	Warm White (WW)
Chromaticity Coordinate X (Nom)	0.436
Chromaticity Coordinate Y (Nom)	0.396
Correlated Color Temperature (Nom)	3000 K
Luminous Efficacy (rated) (Nom)	77 lm/W
Color rendering index (CRI)	91
Arc Length O (Nom)	4 mm
Operating and Electrical	
Power Consumption	39.0 W

Voltage (Nom)	96 V
Voltage (Nom)	96 V
Controls and Dimming	
Dimmable	No
Mechanical and Housing	
Bulb Finish	Clear
Bulb Shape	T13.3 [T 13.3mm]
Approval and Application	
Mercury (Hg) Content (Nom)	2.74 mg
Energy Consumption kWh/1000 h	43 kWh
Product Data	
Order product name	MASTERC CDM-TM MINI 35W/930 PGJ5 KIT/12
Full product name	MASTERC CDM-TM MINI 35W/930 PGJ5 KIT/12

MasterColor CDM-TM

Full product code	871150021292415
Order code	914499997330
Material Nr. (12NC)	914499997330
Numerator - Quantity Per Pack	1
EAN/UPC - Product/Case	8711500212924

Numerator - Packs per outer box	12
EAN/UPC - Case	8711500212931

Dimensional drawing

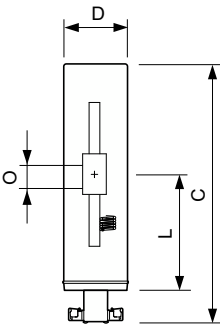

Product	D (max)	D	O	L (min)	L (max)	L	C (max)
MASTERC CDM-TM	13.3 mm	0.44	4 mm	22.3 mm	22.9 mm	22.6	52 mm
MINI 35W/930 PGJ5		inch				mm	
KIT/12							

Photometric data

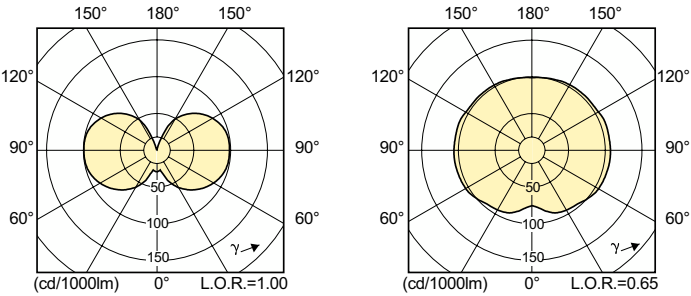

Light Distribution Diagram - MASTERC CDM-TM MINI 35W/930 PGJ5 KIT/12

Spectral Power Distribution Colour

Lifetime

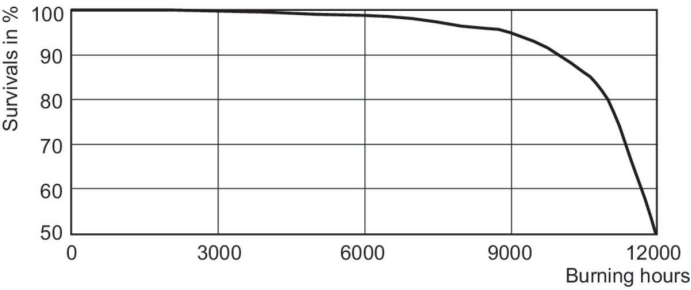

Life Expectancy Diagram - MASTERC CDM-TM MINI 35W/930 PGJ5 KIT/12

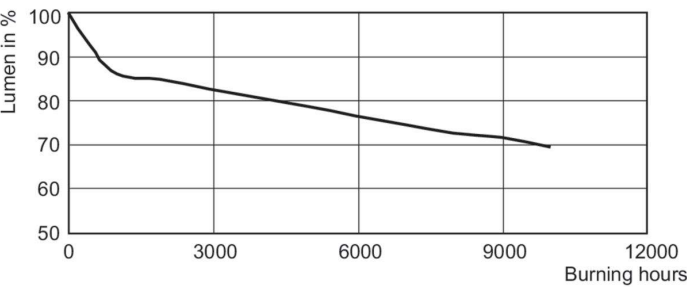

Lumen Maintenance Diagram

