



High Output T12

F72T12/D/HO ALTO 15PK

Philips T12 fluorescent lamps provide high performance in a wide range of sizes, shapes, and types.

Product data

General Information	
Cap-Base	R17D [R17d (RDC)]
Life 3-Hr Start [Hrs]	12000 h
Features	ALTO® (ALTO)
Footnotes Fluorescent/CFL 1	Approximate initial lumens are for 800 ma. operation. For 1000 ma. operation, lumens are approximately 10% higher and watts approximately 15% higher. (207)
Footnotes Fluorescent/CFL 2	Econ-o-watt® lamps are only recommended for use on high power factor lead, indoor ballasts that meet ANSI standards. The lamps are not recommended for use in drafty areas, or locations where the ambient temperature is less than 60°F, except as noted. Also they should not be operated on low power factor ballasts, reduced light or reduced current ballasts, dimming ballasts or emergency system inverter ballasts. (214)

Light Technical	
Color Code	54
Luminous Flux (Nom)	5600 lm
Color Designation	Daylight [Daylight]
Design Mean Lumens	4850 lm
Correlated Color Temperature (Nom)	6500 K

Color Rendering Index (Nom)	79
-----------------------------	----

Operating and Electrical	
Power (Rated) (Nom)	85 W

Mechanical and Housing	
Cap-Base Information	Green Base
Nominal Length (Inch)	72

Approval and Application	
Energy Saving Product	Not Applicable
Mercury (Hg) Content (Nom)	6.8 mg

Product Data	
Order product name	F72T12/D/HO ALTO 15PK
EAN/UPC - Product	046677366537
Order code	366534
Numerator - Quantity Per Pack	1
Numerator - Packs per outer box	15
Material Nr. (12NC)	927893205402
Net Weight (Piece)	0.001 kg

High Output T12

Dimensional drawing

Product

F72T12/D/HO ALTO 15PK

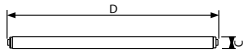

T12 Revised Double Contact

F72T12 85W/54 HO ALTO

