



High Output T12

F72T12/D/HO ALTO 15PK

Philips T12 fluorescent lamps provide high performance in a wide range of sizes, shapes, and types.

Product data

General Information	
Base	R17D [R17d (RDC)]
Life 3-Hr Start [Hrs]	12000 h
Features	ALTO® (ALTO)
Footnotes Fluorescent/CFL 1	Approximate initial lumens are for 800 ma. operation. For 1000 ma. operation, lumens are approximately 10% higher and watts approximately 15% higher. (207)
Footnotes Fluorescent/CFL 2	Econ-o-watt® lamps are only recommended for use on high power factor lead, indoor ballasts that meet ANSI standards. The lamps are not recommended for use in drafty areas, or locations where the ambient temperature is less than 60°F, except as noted. Also they should not be operated on low power factor ballasts, reduced light or reduced current ballasts, dimming ballasts or emergency system inverter ballasts. (214)

Light Technical

Color Code	54
Initial lumen (Nom)	5600 lm
Color Designation	Daylight
Design Mean Lumens	4850 lm
Correlated Color Temperature (Nom)	6500 K

Color Rendering Index (Nom)	79
-----------------------------	----

Operating and Electrical

Power (Rated) (Nom)	85 W
---------------------	------

Mechanical and Housing

Cap-Base Information	Green Base
----------------------	------------

Nominal Length (Inch)	72
-----------------------	----

Approval and Application

Energy Saving Product	Not Applicable
-----------------------	----------------

Mercury (Hg) Content (Nom)	6.8 mg
----------------------------	--------

Product Data

Order product name	F72T12/D/HO ALTO 15PK
--------------------	-----------------------

EAN/UPC - Product	046677366537
-------------------	--------------

Order code	366534
------------	--------

Numerator - Quantity Per Pack	1
-------------------------------	---

Numerator - Packs per outer box	15
---------------------------------	----

Material Nr. (12NC)	927893205402
---------------------	--------------

Net Weight (Piece)	0.001 kg
--------------------	----------

High Output T12

Warnings and Safety

- Lamp contains mercury. Manage in Accord with Disposal Laws. See: www.lamprecycle.org or 1-800-555-0050

Dimensional drawing

Product

F72T12/D/HO ALTO 15PK

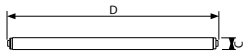

T12 Reversed Double Contact

F72T12 85W/54 HO ALTO

