



# High Output T12

## F84T12/CW/HO/ALTO 15PK

Philips T12 fluorescent lamps provide high performance in a wide range of sizes, shapes, and types.

### Product data

General Information	
Base	R17D [ R17d (RDC)]
Life 3-Hr Start [Hrs]	12000 h
Features	ALTO® (ALTO)

Light Technical	
Color Code	33
Initial lumen (Nom)	7490 lm
Color Designation	Cool White (CW)
Design Mean Lumens	6800 lm
Correlated Color Temperature (Nom)	4100 K
Color Rendering Index (Nom)	62

Operating and Electrical	
Power (Rated) (Nom)	100 W

Mechanical and Housing	
Cap-Base Information	Green Base

Nominal Length (Inch)	84
-----------------------	----

Approval and Application	
Mercury (Hg) Content (Nom)	6.8 mg

Product Data	
Order product name	F84T12 CW HO ALTO 1LP
EAN/UPC - Product	046677234485
Order code	234484
Numerator - Quantity Per Pack	1
Numerator - Packs per outer box	15
Material Nr. (12NC)	927894403301
Net Weight (Piece)	0.001 kg

### Warnings and Safety

• Lamp contains mercury. Manage in Accord with Disposal Laws. See: [www.lamprecycle.org](http://www.lamprecycle.org) or 1-800-555-0050

# High Output T12

## Dimensional drawing

### Product

F84T12 CW HO ALTO 1LP

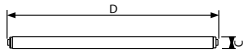

T12 Revised Double Contact

F84T12 100W/33 HO ALTO

