



High Output T12

F96T12/D/HO-O ALTO 15PK

Philips T12 fluorescent lamps provide high performance in a wide range of sizes, shapes, and types.

Product data

General Information	
Base	R17D [R17d (RDC)]
Life 3-Hr Start [Hrs]	12000 h
Features	ALTO® (ALTO)
Footnotes Fluorescent/CFL 1	Meets the National Energy Policy Act of 1992 exemption for outdoor or cold temperature applications only. (223)

Light Technical	
Color Code	54
Initial lumen (Nom)	7800 lm
Color Designation	Daylight
Design Mean Lumens	6800 lm
Correlated Color Temperature (Nom)	6500 K
Color Rendering Index (Nom)	79

Operating and Electrical	
Power (Rated) (Nom)	110 W

Mechanical and Housing	
Cap-Base Information	Green Base
Nominal Length (Inch)	96

Approval and Application	
Energy Saving Product	Not Applicable
Mercury (Hg) Content (Nom)	6.8 mg

Product Data	
Order product name	F96T12/D/HO-O ALTO 15PK
EAN/UPC - Product	046677381776
Order code	381774
Numerator - Quantity Per Pack	1
Numerator - Packs per outer box	15
Material Nr. (12NC)	927895205408
Net Weight (Piece)	0.694 kg

Warnings and Safety

• Lamp contains mercury. Manage in Accord with Disposal Laws. See: www.lamprecycle.org or 1-800-555-0050

High Output T12

Dimensional drawing

Product

F96T12/D/HO-O ALTO 15PK

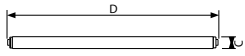

T12 Revised Double Contact

F96T12 110W/54 HO-O ALTO

