



# Very High Output T12

## F96T12/CW/VHO/EW 15PK

Philips T12 fluorescent lamps provide high performance in a wide range of sizes, shapes, and types.

### Product data

General Information		Nominal Length (Inch)	
Base	R17D [ R17d (RDC)]	96	
Life 3-Hr Start [Hrs]	12000 h	Approval and Application	
Light Technical		Energy Saving Product	Energy Saving
Color Code	33	Mercury (Hg) Content (Nom)	25.0 mg
Initial lumen (Nom)	13000 lm	Product Data	
Color Designation	Cool White (CW)	Order product name	F96T12/CW/VHO/EW 15PK
Design Mean Lumens	9000 lm	EAN/UPC - Product	046677342326
Correlated Color Temperature (Nom)	4100 K	Order code	342329
Color Rendering Index (Nom)	62	Numerator - Quantity Per Pack	1
Operating and Electrical		Numerator - Packs per outer box	15
Power (Rated) (Nom)	185 W	Material Nr. (12NC)	927895503304
Mechanical and Housing		Net Weight (Piece)	0.001 kg
Cap-Base Information	Aluminium [ Aluminium Cap]		

### Warnings and Safety

• Lamp contains mercury. Manage in Accord with Disposal Laws. See: [www.lamprecycle.org](http://www.lamprecycle.org) or 1-800-555-0050

# Very High Output T12

## Dimensional drawing

### Product

F96T12/CW/VHO/EW 15PK

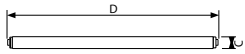

T12 Revised Double Contact

F96T12 185W/33 VHO/EW ES

