



# MASTER LEDspot LV AR111

## MAS LEDspotLV D 20-100W 840 AR111 40D

Delivering a warm, halogen-like accent beam, MASTER LEDspot LV AR111 is an ideal retrofit solution for spot and general lighting applications in the hospitality and retail industry. It is particularly suitable for general lighting where the light is on all the time, such as creative accent lighting applications in shops, restaurants, hotels, and especially for galleries, exhibitions and museums. The robustly designed MASTER LEDspot LV AR111 offers various beam angles for a clearly defined beam spread. There is no UV or IR in the beam, making it suitable for illuminating heat-sensitive objects (food, organic materials, paintings, etc.). The patented intelligent driver enables broad compatibility with existing electromagnetic and electronic halogen transformers. MASTER LEDspot LV AR111 delivers huge energy savings and minimizes maintenance cost without any reduction in brightness.

### Product data

General Information		Operating and Electrical	
Cap-Base	G53 [ G53]	Luminous Efficacy (rated) (Nom)	70 lm/W
EU RoHS compliant	Yes	Color Consistency	<6
Nominal Lifetime (Nom)	25000 h	Color Rendering Index (Nom)	80
Switching Cycle	50000X	LLMF At End Of Nominal Lifetime (Nom)	70 %
Technical Type	20-100W	Operating and Electrical	
Light Technical		Input Frequency	- Hz
Color Code	841 [ CCT of 4100K (841)]	Power (Rated) (Nom)	20 W
Beam Angle (Nom)	40 °	Lamp Current (Nom)	2400 mA
Luminous Flux (Nom)	1400 lm	Wattage Equivalent	100 W
Luminous Intensity (Nom)	2350 cd	Starting Time (Nom)	0.5 s
Color Designation	Cool White (CW)	Warm Up Time to 60% Light (Nom)	instant full light
Correlated Color Temperature (Nom)	4000 K	Power Factor (Nom)	0.7

# MASTER LEDspot LV AR111

Voltage (Nom)	12 V
<b>Temperature</b>	
T-Case Maximum (Nom)	80 °C
<b>Controls and Dimming</b>	
Dimmable	Yes
<b>Approval and Application</b>	
Energy Efficiency Label (EEL)	Not applicable
Suitable For Accent Lighting	Yes
Energy Consumption kWh/1000 h	22 kWh

## Dimensional drawing

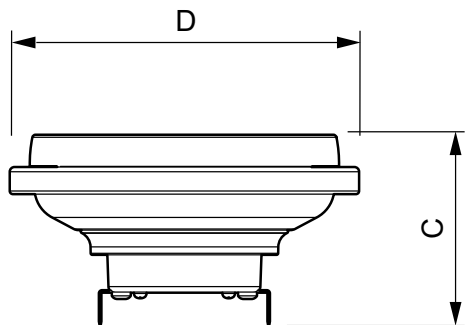

LED D 20-100W 840 AR111 40D

## Photometric data

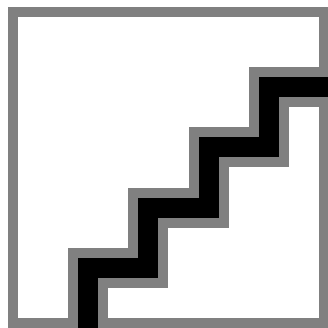

MASTER LEDspot LV AR111 100W G53 840 40D

<b>Product Data</b>	
Full product code	871869651530300
Order product name	MAS LEDspotLV D 20-100W 840 AR111 40D
EAN/UPC - Product	8718696515303
Order code	929001171308
Numerator - Quantity Per Pack	1
Numerator - Packs per outer box	6
Material Nr. (12NC)	929001171308
Net Weight (Piece)	0.360 kg

<b>Product</b>
MAS LEDspotLV D 20-100W 840 AR111 40D

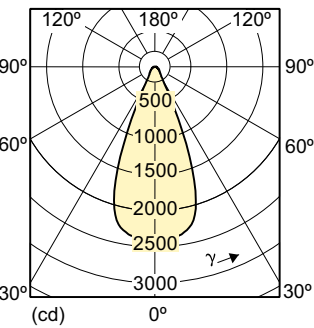

20-100 W GX53 /840 AR111 40D

# MASTER LEDspot LV AR111

## Photometric data

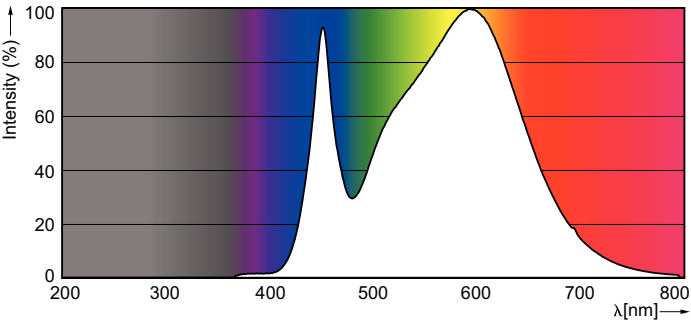

20-100W AR111 /840

## Lifetime

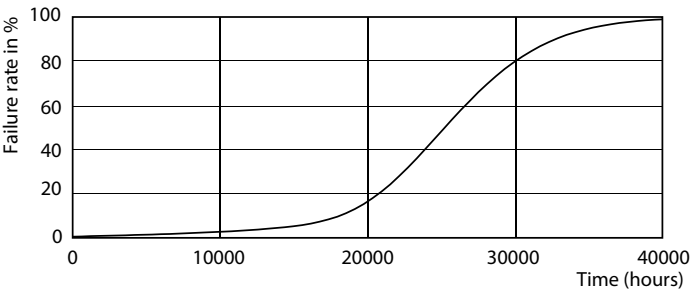

MASTER LEDspotLV AR111 100W G53 40D

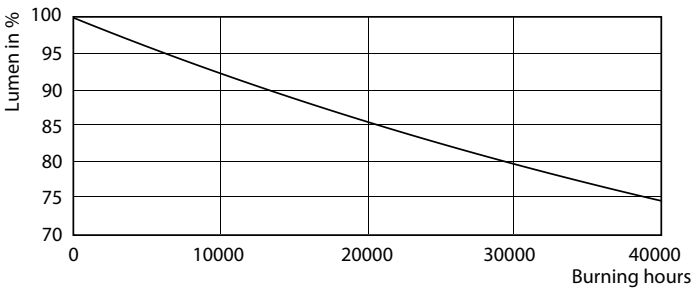

MASTER LEDspotLV AR111 100W G53 40D

